

# GO Maxi Remote Control

## User Guide



### 1. Remote control layout

- 1 TV input source select
- 2 TV/AUX power/standby
- 3 Colour navigation
- 4 'A' button - (for future use)
- 5 Video trick-play function
- 6 Apps
- 7 Navigation and OK
- 8 Back
- 9 Volume up and down
- 10 Channel select and text entry
- 11 Information
- 12 Search
- 13 Infra-red (IR) window
- 14 Microphone
- 15 STB (GO Android TV Box) power/standby
- 16 'GO TV' button
- 17 'B' button - (for future use)
- 18 Electronic Program Guide
- 19 Google home page
- 20 Voice control
- 21 Channel/Page up and down
- 22 Mute
- 23 Subtitles/closed captions
- 24 Last channel recall
- 25 Low battery warning LED

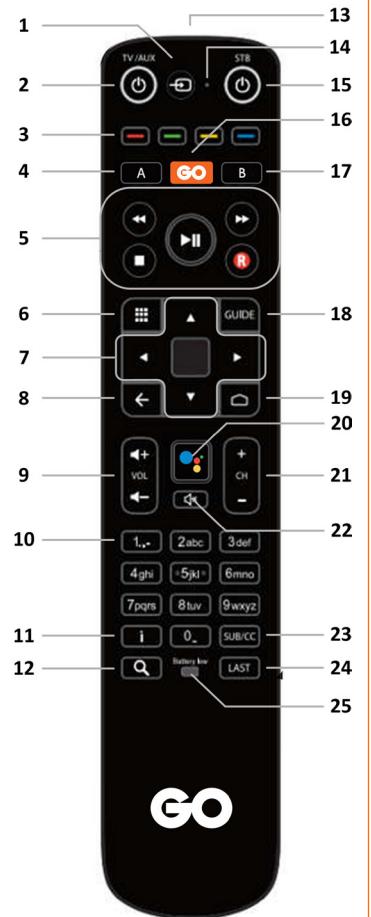

**Note:** Some functionality may depend on the service you are subscribed to.

### 2. Inserting batteries

- 1 Slide the battery housing cover downwards to remove



- 2 Insert 2 x AAA batteries observing the correct polarity



- 3 Refit the battery housing cover



### Battery information

- Do not mix different types of battery or old and new batteries.
- Do not use rechargeable batteries.
- Remove the batteries from the remote control if you are not going to use it for several weeks, to avoid the risk of leakage.
- Please respect your environment and any local regulations and dispose of old batteries in a responsible manner.
- Do not attempt to recharge the batteries.
- Immediately remove any leaking batteries.
- Take care when handling leaking batteries as they may cause burns to the skin or eyes, or other physical injuries.

### 3. Operation

When you press a key, point the remote control towards the front of the STB to ensure correct operation. Do not cover the infra-red (IR) window at the front of the remote control and at the front of the STB.

When a key is pressed, either the STB key will flash or, if a TV brand has been entered, the TV/AUX POWER key will flash, depending on which product is being controlled by the remote control.

If you press a key for more than 30 seconds the remote control will stop transmitting commands to preserve battery life.

#### 4. Controlling the STB (pairing the remote control)

During initial setup of the STB device, you will be guided through the process of pairing the remote control to your STB. Make sure to remove the transparent plastic strip from the remote control before initiating the setup process.

The below screen is what you can expect to see giving visual instructions of how to pair the remote control.

1. Press and hold the OK and APPS buttons simultaneously for 5 seconds or until the STB button blinks twice.
2. Release the buttons
3. The STB button should be illuminated Blue.

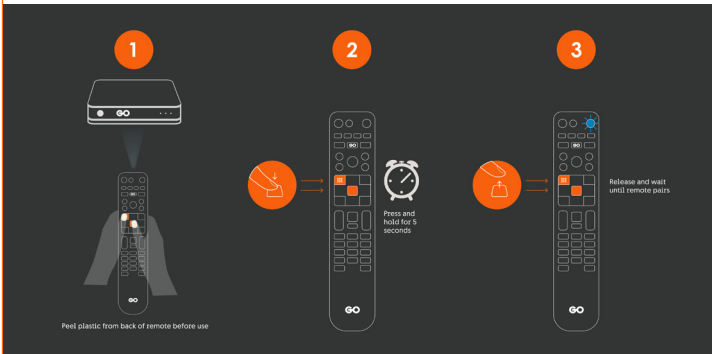

Once the pairing is successful, you will see a short blink and the pairing screen will be hidden.

Note: The remote is in "pairing mode" when the STB button is illuminated blue. During pairing mode, no remote control keys will work except the BACK key. You must press BACK to stop pairing or to use another function.



#### 5. Controlling the TV

The Maxi remote control with Android TV supports a "Simple Remote Wizard" which will automatically detect the TV your STB is connected to via HDMI, and then program the remote control to control that device. The remote wizard will walk you through the steps to confirm the remote is able to control your TV. Below is the first screen of the Simple Remote Wizard.

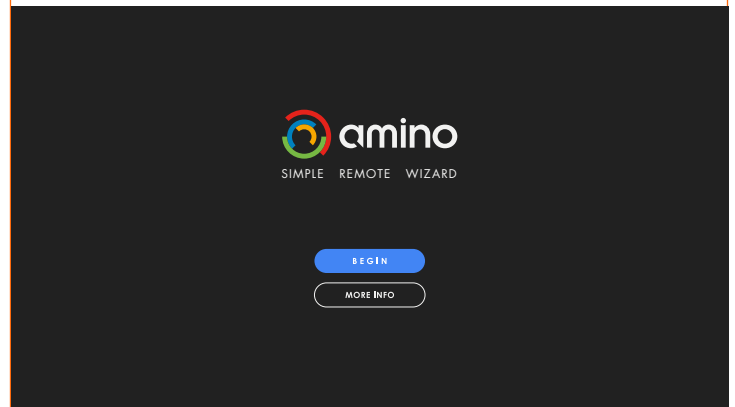

If you receive a new remote control, you can trigger the Simple Remote Wizard by going to Settings > Device Preferences > Remotes and Accessories > then select your remote control from the list and chose "Simple Setup".

When the Simple Remote Wizard completes, the TV/AUX POWER / TV INPUT / VOL+ / VOL- / MUTE buttons will control your TV set. You can chose to switch the VOL+ / VOL- / MUTE buttons to control the STB device instead of TV set by using the following key combination:

Volume buttons control STB device: Apps and 4 - hold for 3 seconds.

Volume buttons control TV set: Apps and 3 - hold for 3 seconds.

#### What if my TV/Aux device cannot be found? (IR Learning)

The Maxi ATV remote control can learn a key function from another 'source' remote control.

1. Choose your 'target key' on the remote control. It must be one of the following keys: TV/AUX POWER / TV INPUT / VOL+ / VOL- / MUTE. This key will learn a function from the source remote control.
2. Press 4 and 6 for at least three seconds. The TV/AUX POWER key will flash twice and remain on.
3. Press your target key within 30 seconds:
  - if valid, the TV/AUX POWER key will give a confirmation flash and remain on.
  - if invalid, or you do not press within 30 seconds, the TV/AUX POWER key will give a long flash and return to user mode.
4. Hold the Maxi ATV remote control 3 - 6 cm from the source remote control with the IR windows facing each other, then press your target key on the source remote control [e.g. if your target key on the Maxi ATV remote control is mute, press mute on the source remote control].
5. If the IR signal is received correctly, the TV/AUX POWER key will turn off and the remote control will return to normal mode (note: this can overwrite a previously learned code).
6. If the IR signal is not received correctly, or is received after 30 seconds, the Maxi ATV remote control will not store the code from the source remote control: it will give a long flash and return to user mode.
7. If the Back key is pressed on the remote control while it is waiting for an IR signal, the TV/AUX POWER key will give a long flash and return to user mode. [If the target key is pressed, any learned code on it is cleared.]
8. To clear the target key, press 4 and 6 for at least three seconds. The TV/AUX POWER key will flash twice and remain on. Then press your <target key> twice. The TV/AUX POWER key will flash to confirm the target key is cleared.

#### How do I return my remote to Factory Settings?

1. Press 1 and 6 for at least three seconds until the TV/AUX POWER key flashes twice then stays on.
2. Enter the key sequence 9 8 1. After completing the sequence the STB key will flash twice. The TV settings are now deleted from the remote control and it returns to factory settings: Bluetooth mode, and unpaired.